



RIMURA[®]
I T A L I A N D E S I G N

DATA SHEET

CLASSIC WALLPAPER
WP01 – WP02

CLASSIC WALLPAPER

WP01 – WP02

Classic surface in properties, innovative in material.

*vinilic Wallpaper with **non-woven fabric** for the traditional **wall or canvas** effect.*

Ideal for all environments.

- **Composition:**

paper with vinyl coating and non-woven substrate

- **Fire reaction classification**

EN 13501-1 B-s1,d0

- **Washable with a damp cloth**

- **Removable in one piece**

- **A+ certification** for indoor air healthiness

- **CE marking** EN 15102:2007+A1:2011

- **Bio-Pruf™ antibacterial treatment**

Which inhibits the growth of microorganisms such as bacteria and fungi. In environments such as hospitals and health centers where conditions of sterility and hygiene are of the utmost importance. Architects and technicians increasingly request this kind of treatment.

- **Odorless inks** with low environmental impact **Greenguard certificates**

- **Adhesive included:**

ACM ADHESIVA

- **Roll width 66 cm**

- **Weight 350 gr/m²**

WALL EFFECT SURFACE
MATTE FINISH (350 GR/M²)

ROUGH | ART. WP01



CAVAS EFFECT SURFACE
MATT FINISH (350 GR/M²)

CANVAS | ART. WP02



HANGING INSTRUCTIONS

CLASSIC WALLPAPER
Art. WP01-WP02
TNT BASE VINYL

ATTENZIONE:

follow the instructions carefully before proceeding with laying the covering.

Material provided

PRIMER
PRIMER SP

ADHESIVE
ADHESIVA TNT

Do not use the adhesive on non-absorbent substrates (glass, ceramic, laminates) For applications on non-absorbent substrates, the adhesive must be used **VICEVERSA SPECIAL 2.0** (not provided)

(NOT PROVIDED)
PROTECTIVE
(OPTIONAL)
VICEVERSA PU COAT



SCAN THE QR CODE
AND WATCH THE HANGING
TUTORIAL VIDEO

RIMURA
ITALIAN DESIGN

RIMURA
ITALIAN DESIGN

Via Grotte, 68/A
70013 Castellana Grotte (Ba)

Tel./Whats'app +39 080 40 51 555
info@rimura.com - rimura.com

① BEFORE STARTING

The Wallcovering

Although the paper is already checked during production, we still ask you to check it again carefully in order to avoid unpleasant mistakes for which we will not be held responsible once the paper has been placed.

Before starting the installation:

- 1 Allow the wallcovering to acclimatize to the room temperature for 24h before installation. Work in a dry environment with a temperature between 16 ° and 35 ° and avoid any drafts. In humid and cold periods, heat the space before, during and after installation. Installation in humid, cold or draughty environments can cause paper shrinkage, stains or wrinkles, for which we cannot be held responsible.
- 2 Consult the assembly diagram provided, **ATTENTION:** read the **NOTES FOR THE INSTALLER** in the assembly diagram
- 3 Check the dimensions of the wall and the paper, verify that the graphics on the paper match the graphics on the mounting pattern.
- 4 Check that the strips are in good condition, that they are not damaged and that the edges between one strip and the next are regular.

② PREPARATION

The walls

- 1 Check the condition of the walls to be covered.
- 2 Make sure that the walls are uniform white, dry, absorbent, clean, smooth, solid, free from mold or algae and that there are no plaster granule residues.
- 3 If necessary, resolve the problems in point 2 before starting the installation.
- 4 Apply a coat of PRIMER SP diluted 1:2 (1L of PRIMER SP in 2L of water) over the entire surface and let it dry for 3/4 hours at 20°-23°.



- 5 The surface is now ready.



The adhesive

- 6 Dilute 250 grams of ADHESIVA TNT in 6 liters of water. Shake the water with a medium speed drill quickly pour the powder. Leave to rest for 3 minutes and shake again. ADHESIVA TNT is ready after 5 minutes

③

HANGING THE WALLCOVERING

- 1 Find the center of the wall. If there are an odd number of strips, start with the central strip.

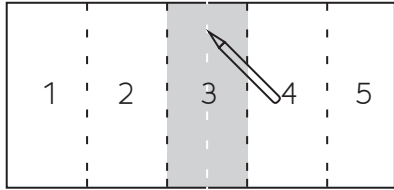

- 2 If there are an even number of strips, start with the one to either the right or left of the central line. Use a plumb line or a laser level to mark and number the strips.

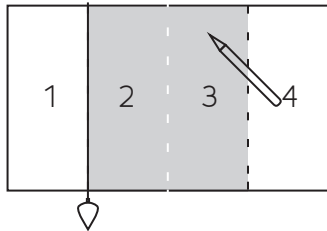

- 3 At this point, apply the adhesive abundantly and evenly directly on the wall using a medium-haired roller or, where necessary, a brush. N.B.: Apply the adhesive evenly to the sections of the wall, proceeding one strip-width at a time.

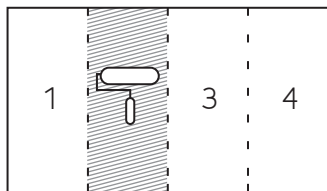

④

HANGING THE WALLCOVERING

- 4 Position the wallcovering on the wall respecting the 'NOTES FOR THE INSTALLER' indicated in the assembly sheet, being careful to follow the vertical line and gently press it onto the wall using a smoothing brush. In case of an imperfect hanging, carefully detach the strip and repeat the operation.

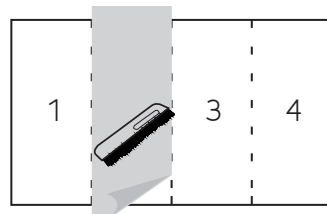

- 5 Continue hanging one strip at a time and carefully draw the strips together, they must be well lined up, not overlapping or separated, and must give continuity to the design. Apply the successive strips in the same way.

- 6 Use a rigid plastic spatula to remove any excess adhesive and eliminate any air bubbles.

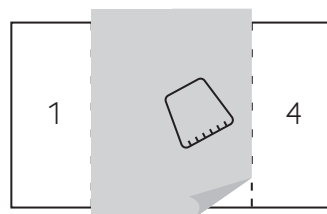

⑤

HANGING THE WALLCOVERING

- 7 As soon as a strip has been hung, immediately remove any glue residues with a soft, damp cloth. Then use a plastic roller to make the edges of the strips adhere perfectly to the wall.

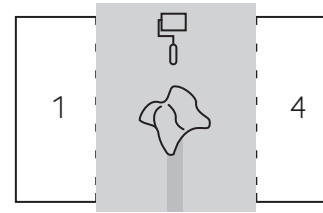

- 8 Trim around the entire perimeter overlap, using a cutter. Use a metal straight edge as a guide for a straight cut.

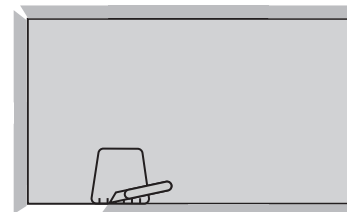

- 9 When the strip has to turn around an inside corner onto a wall that is not perfectly plumb, it is advisable to cut the strip.

- 10 If the strip has to turn around an outside corner wall it is advisable to continue without cutting the strip.

⑥

RECOMMENDATIONS AND CONDITIONS

- 1 For environments with a high level of people traffic or at high risk of scratches and stains, it is possible to protect the print with VICEVERSA PU COAT water-repellent.
- 2 24 hours after applying the coating, a crossed coat of VICEVERSA PU COAT two-component protective finish can be applied with a closed-cell sponge roller. The product must be used within 90 minutes of mixing.

Cleaning

- 3 The wallcovering can be washed with a damp cloth and neutral soap.

DO NOT USE SOLVENTS

